

Cutout dimension see sheet
2, forces see sheet 3

*To be adapted on site
**Customized panel

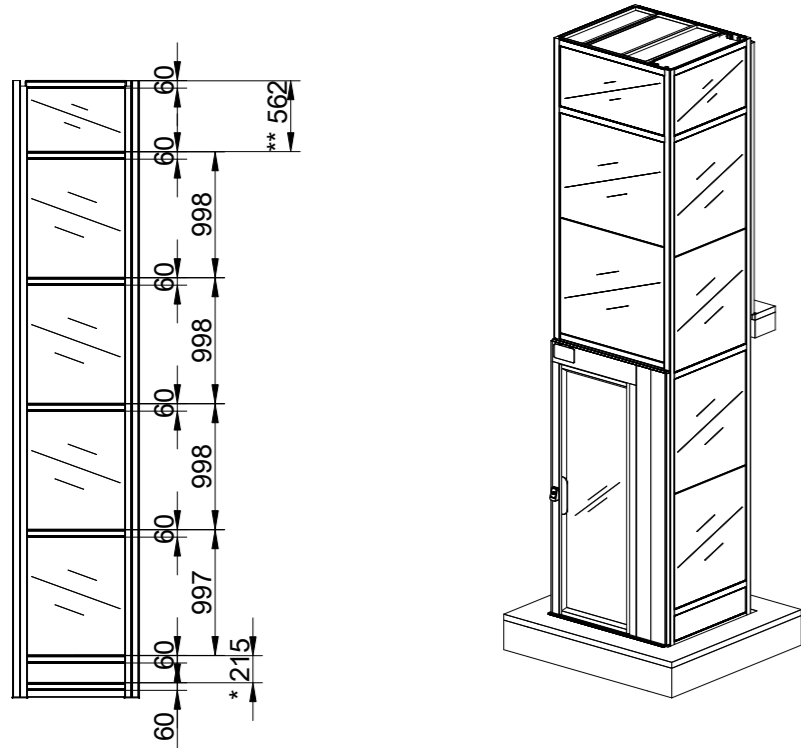

E

Positioning of machinery:

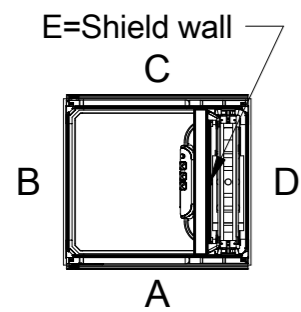

A

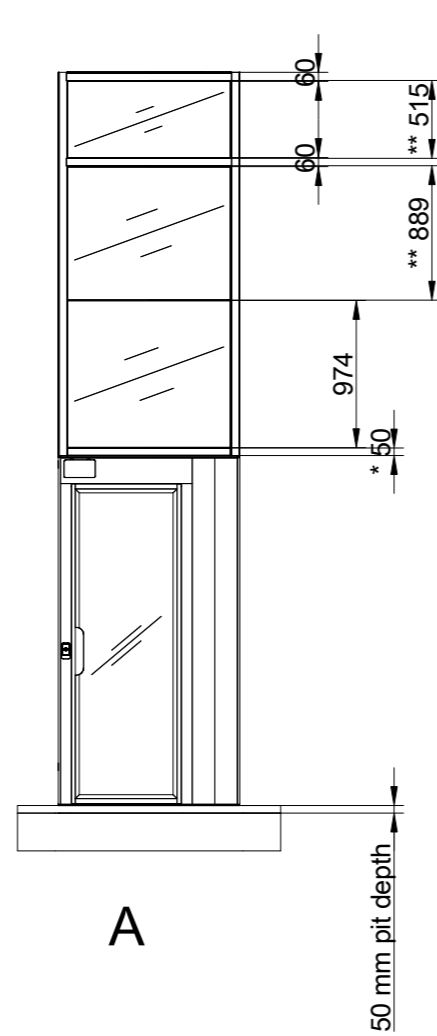

A

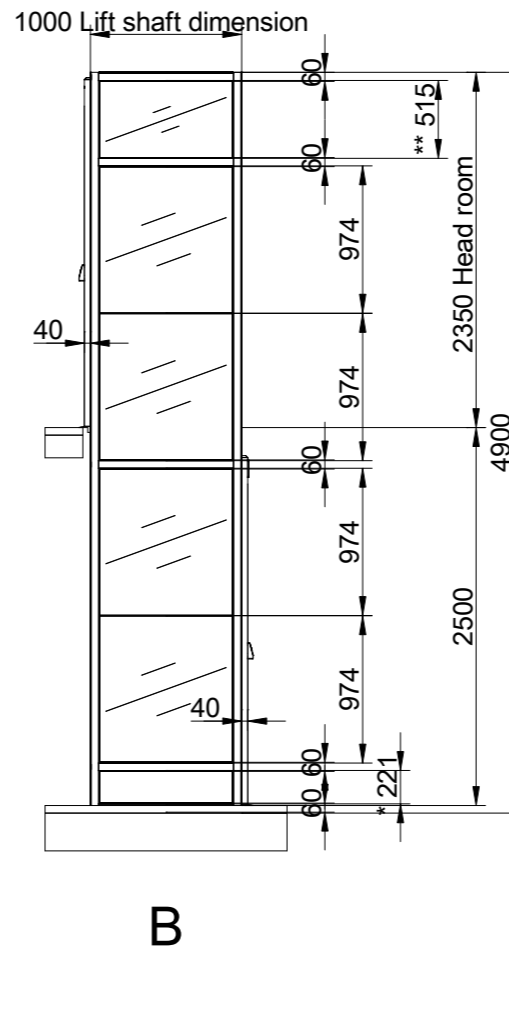

B

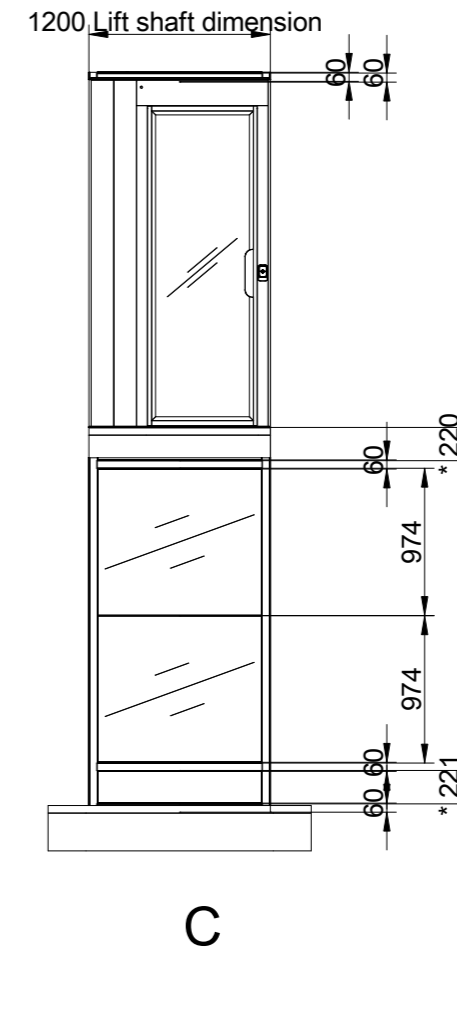

C

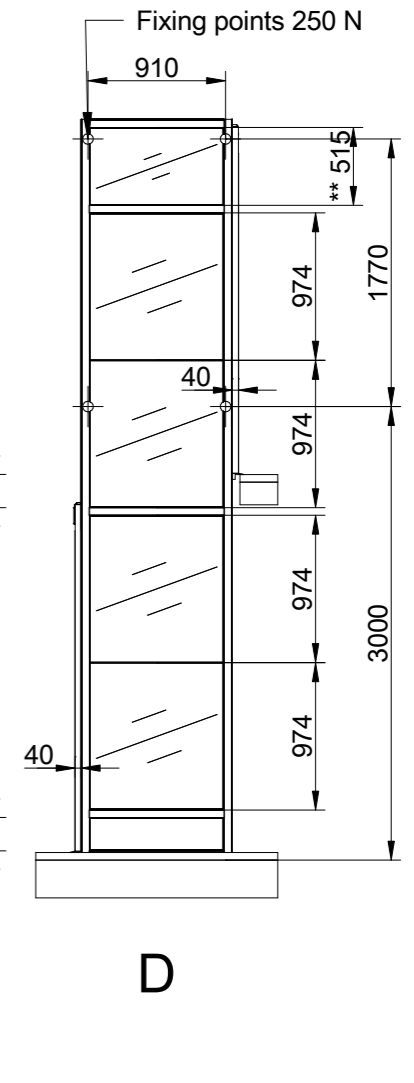

D

Options
300 kg
Power supply 1x230

Approved by builder:

European view placement:



Tender no
202305031032

Gen. Tolerances
SS-ISO 27681-1 m

Principal drawing

1 - 825*950

Shaft drawing

Kalea 825x950

Date
2023-05-03
06:15

sheet
1 of 6

Scale:
A3, 1:50

Shaft cutout sizes

Door front cutout sizes		
Landing	Width	Height
A 0	1240	2315
C 1	1240	2315

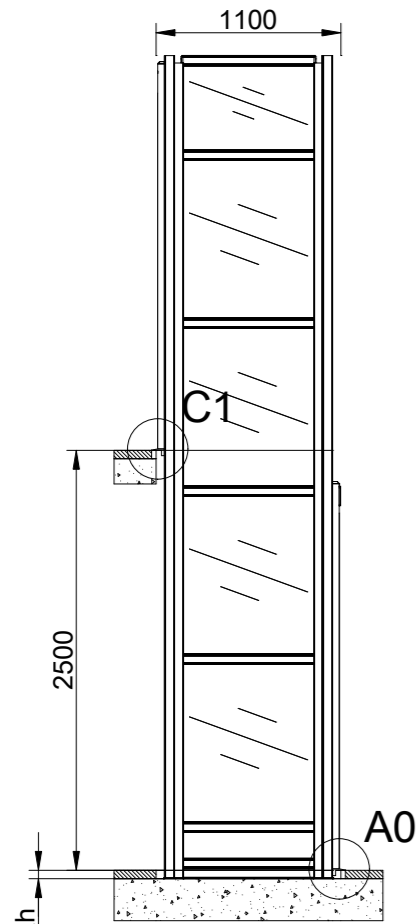
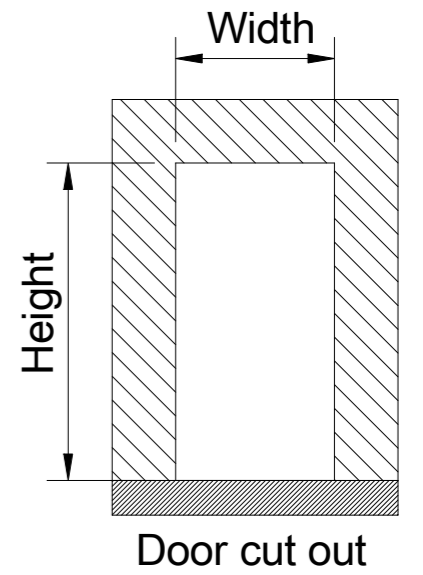

Section E-E

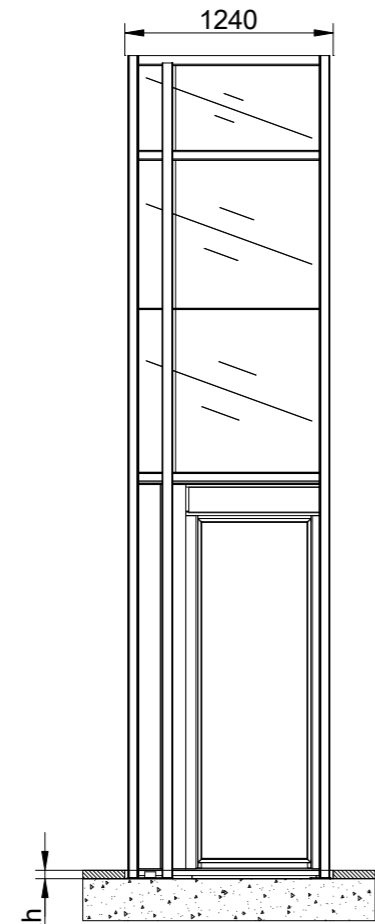

Section G-G

50 mm pit depth + 10 mm, - 0 mm.
Bottom surface must be flat

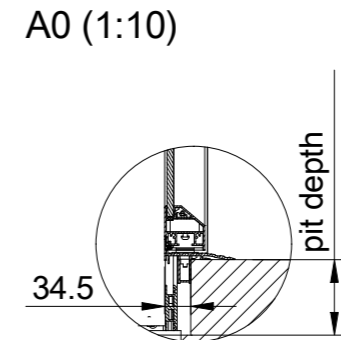
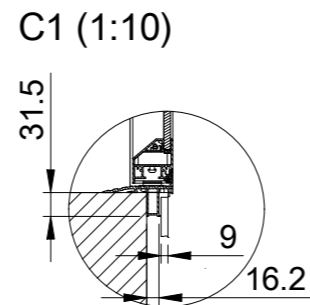
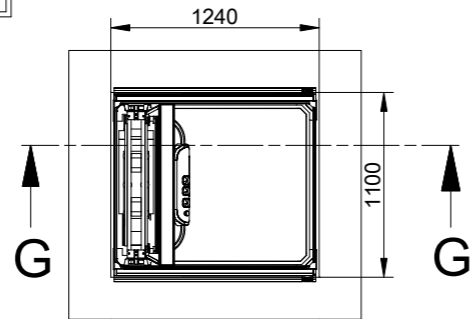
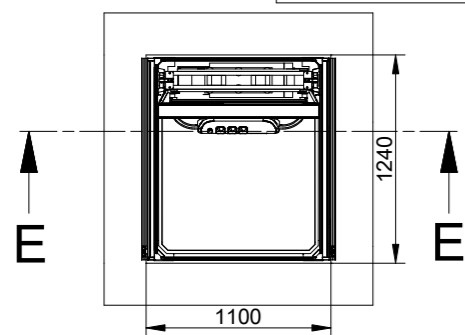

Approved by builder:

European view placement:



Tender no
202305031032

Gen. Tolerances
SS-ISO 27681-1 m

Principal drawing

1 - 825*950

Cut out sizes

Kalea 825x950

Date
2023-05-03
06:15

sheet
2 of 6

Scale:
A3, 1:50

6 5 4 3 2 1

Loads sustained by shaft and platform
and fixing points bottom frame

Recommended positioning of fixing points.
Loads per fixing point, F=250 N



L section force: 3 kN
L section load:
Weight on L-section
area: 300 kg



Mast force: 10.93 kN
Mast load:
Weight on mast area (including rated load) 1093 kg

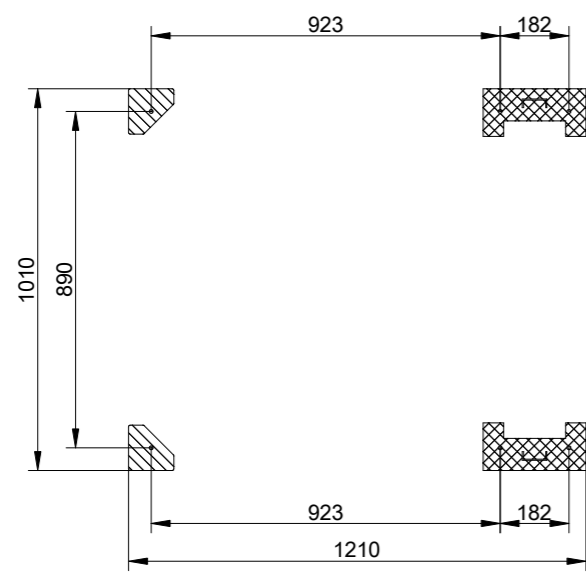

Scale: 1:20

Total weight of the lift equipment (including rated load)
1392 kg

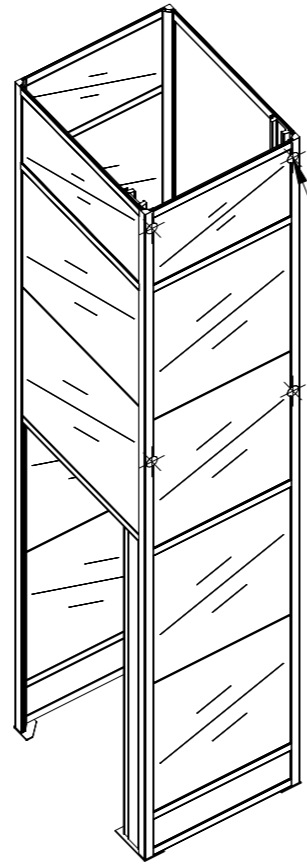

Fixing points 2500 N
See detail A

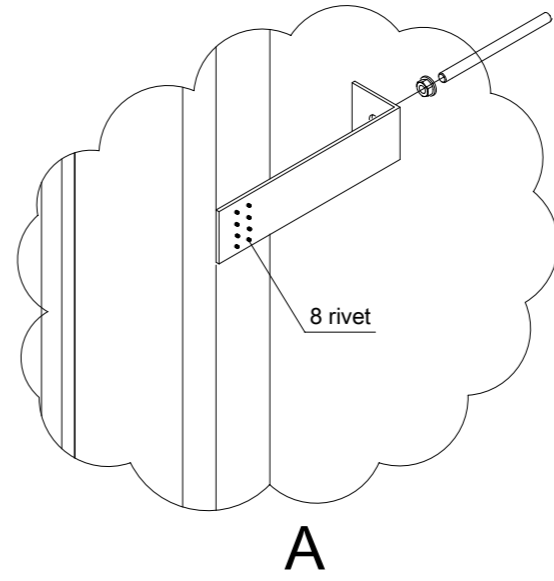

D

C

B

A

D

C

B

A

6 5 4 3 2 1

Approved by builder:

European view placement:



Tender no 202305031032	
Gen. Tolerances SS-ISO 27681-1 m	Date 2023-05-03 06:15

Principal drawing 1 - 825*950 Loads and forces Kalea 825x950	
sheet 3 of 6	Scale: A3, 1:50

Landing 0 and door front information
Scale: 1:20

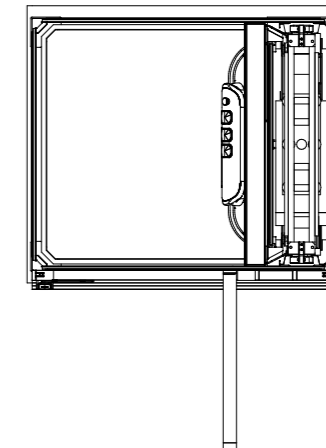
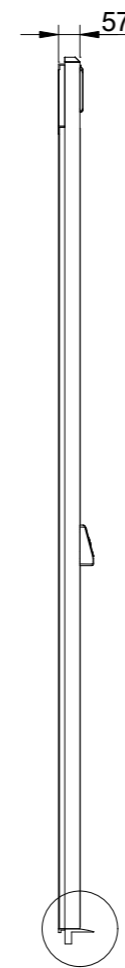
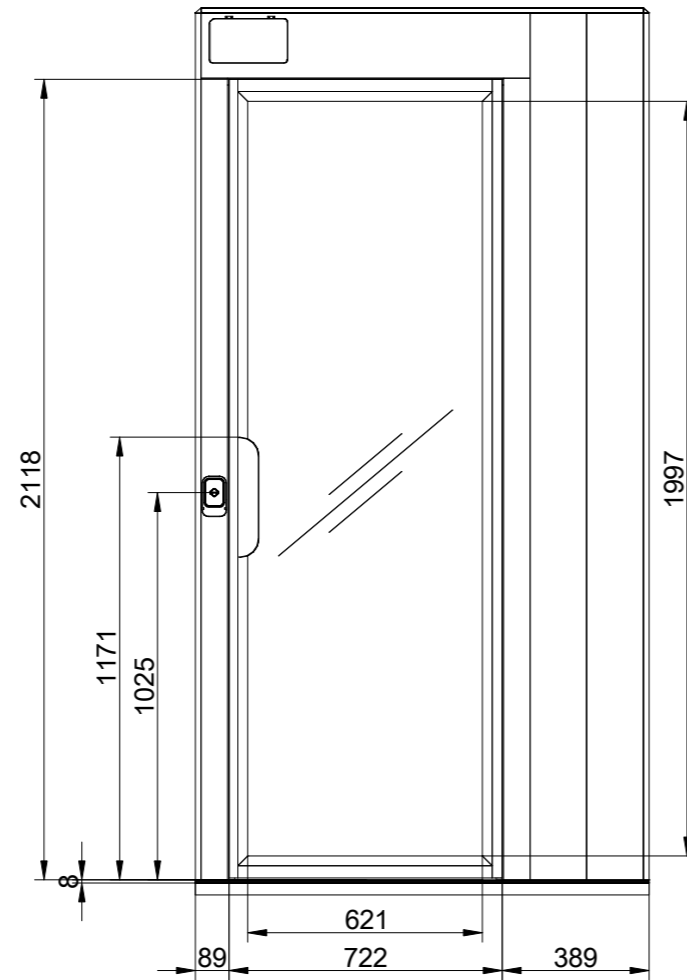
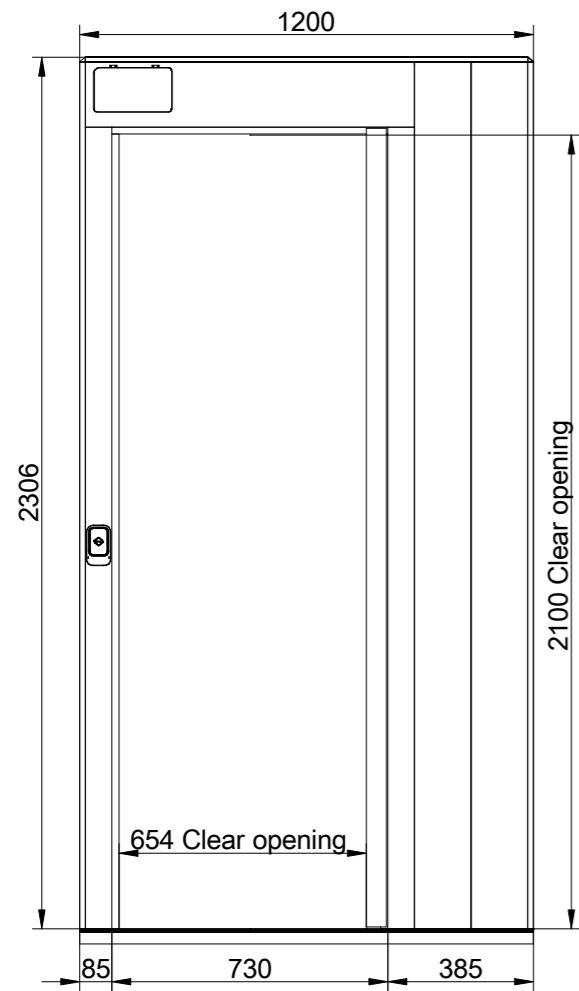

Scale: 1:30

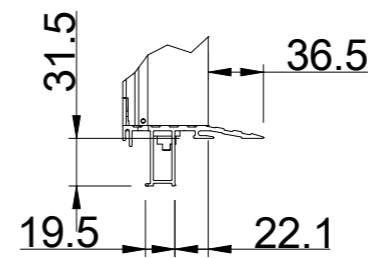

A (1:5)

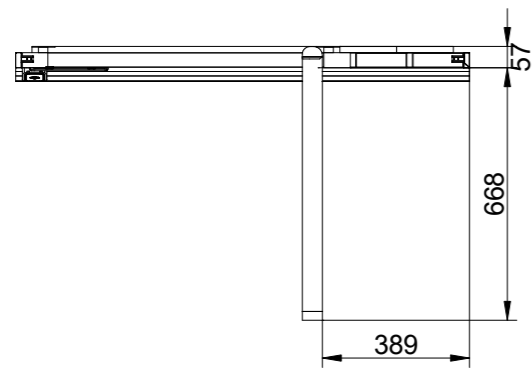

Landing	Door type
0	Panoramic Plus
1	Panoramic Plus

Approved by builder:

European view placement:



Tender no
202305031032

Gen. Tolerances
SS-ISO 27681-1 m

Principal drawing

1 - 825*950

Cut out sizes

Kalea 825x950

Date
2023-05-03
06:15

sheet
4 of 6

Scale:
A3, 1:50

Landing 1 and door front information
Scale: 1:20

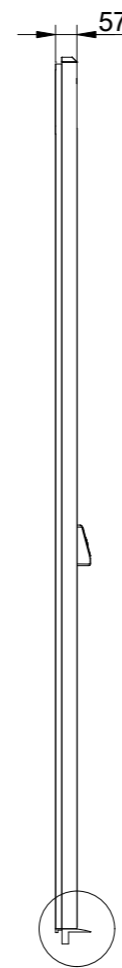
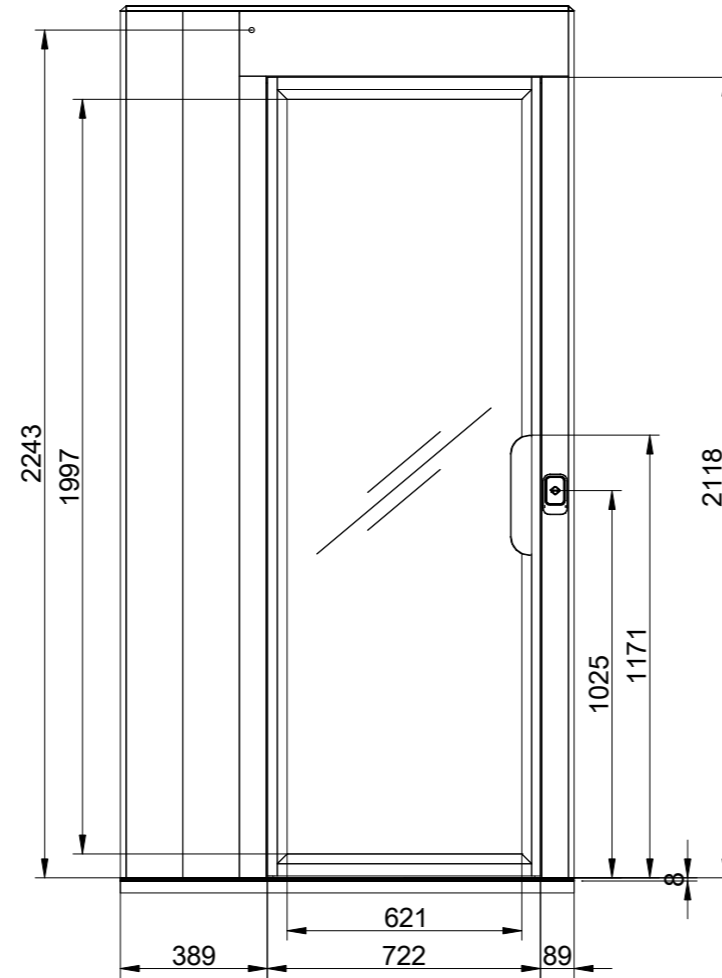
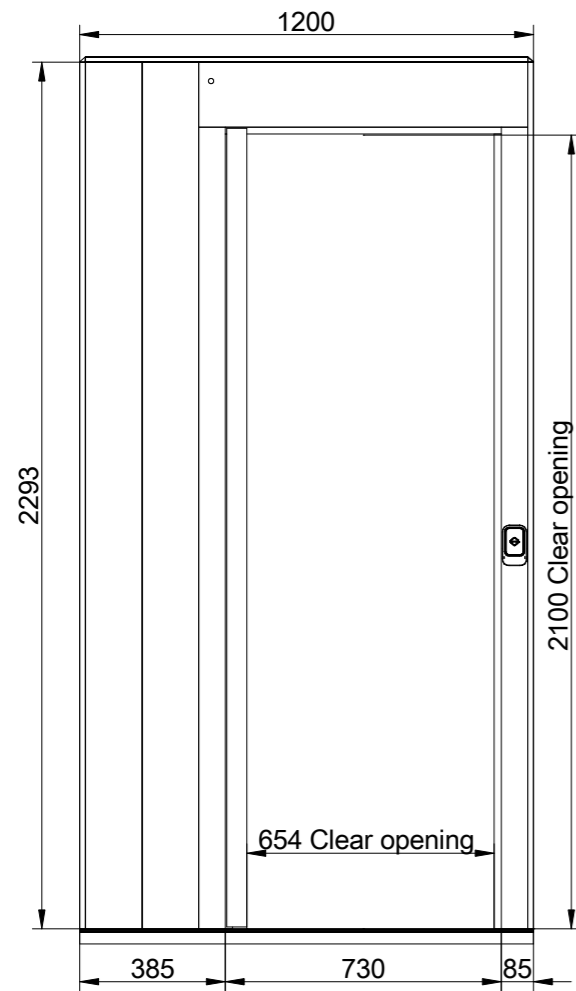

A

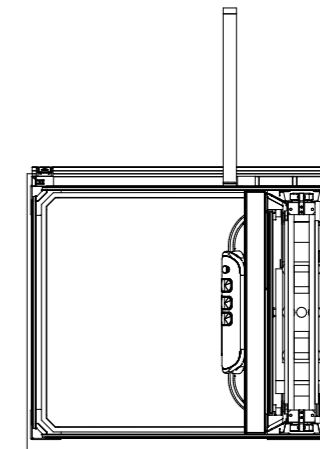

Scale: 1:30

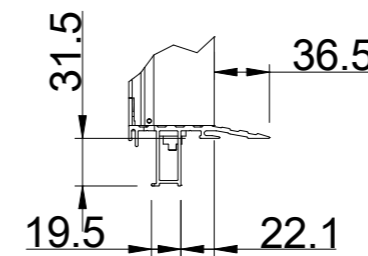
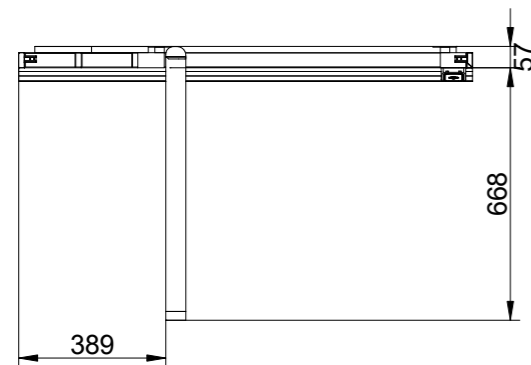

A (1:5)

Landing	Door type
0	Panoramic Plus
1	Panoramic Plus

Approved by builder: _____	KALEA LIFTS	Principal drawing		
		1 - 825*950		
European view placement:	Tender no 202305031032	Landing information		
		Kalea 825x950		
	Gen. Tolerances SS-ISO 27681-1 m	Date 2023-05-03 06:15	sheet 5 of 6	Scale: A3, 1:50

6 5 4 3 2 1

Platform layout
Scale: 1:15

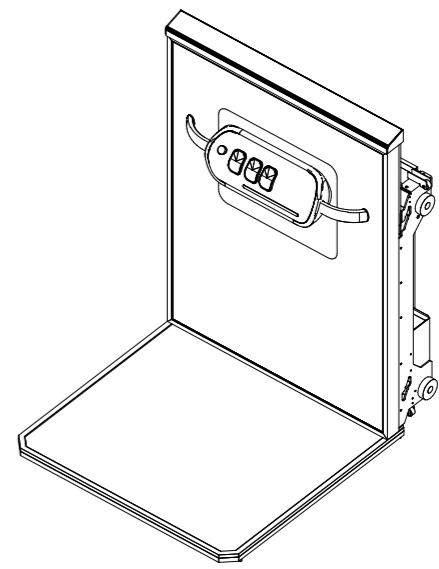
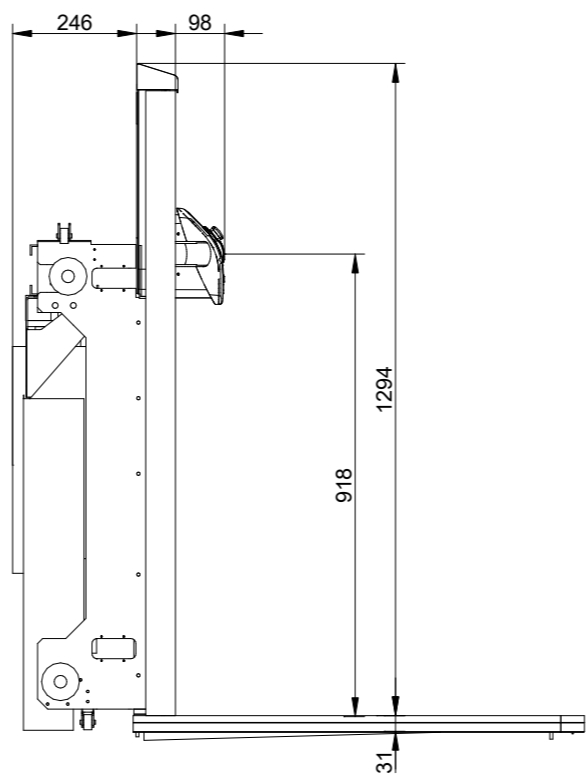
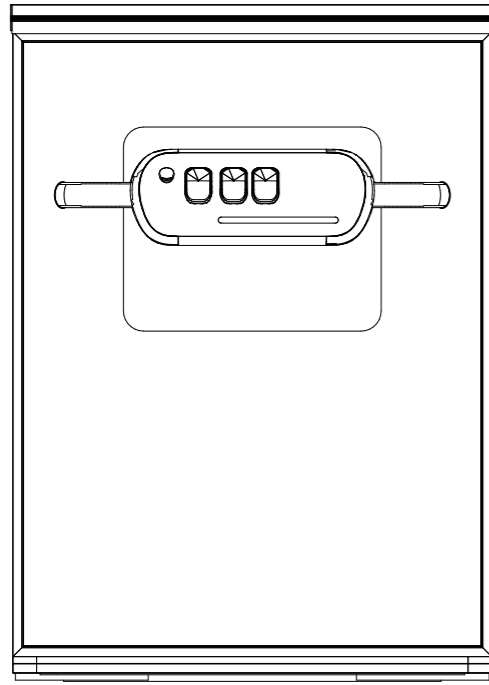

D

D

C

C

Button layout
Scale: 1:10

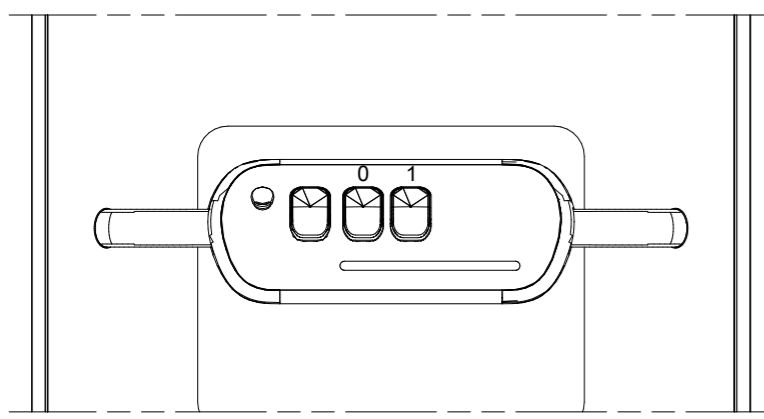

Platform dimensions
Scale: 1:15

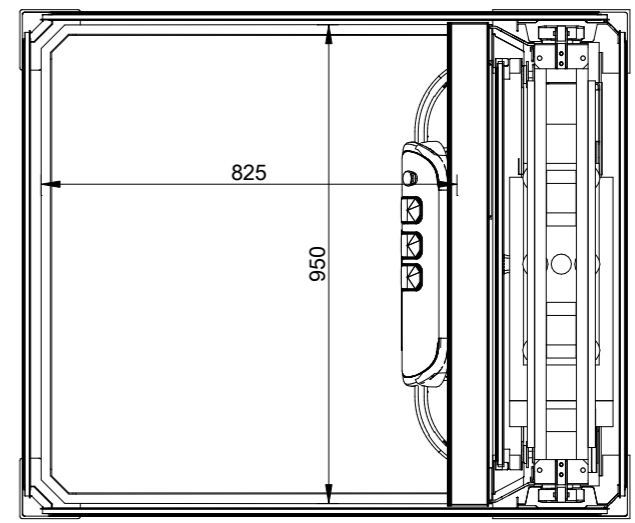

B

B

A

A

6 5 4 3 2 1

Approved by builder:



Tender no
202305031032

Principal drawing
1 - 825*950
Platform layout
Kalea 825x950

European view placement:

Gen. Tolerances
SS-ISO 27681-1 m

Date
2023-05-03
06:15

sheet
6 of 6

Scale:
A3, 1:50

