

Cutout dimension see sheet  
2, forces see sheet 3

\*To be adapted on site  
\*\*Customized panel

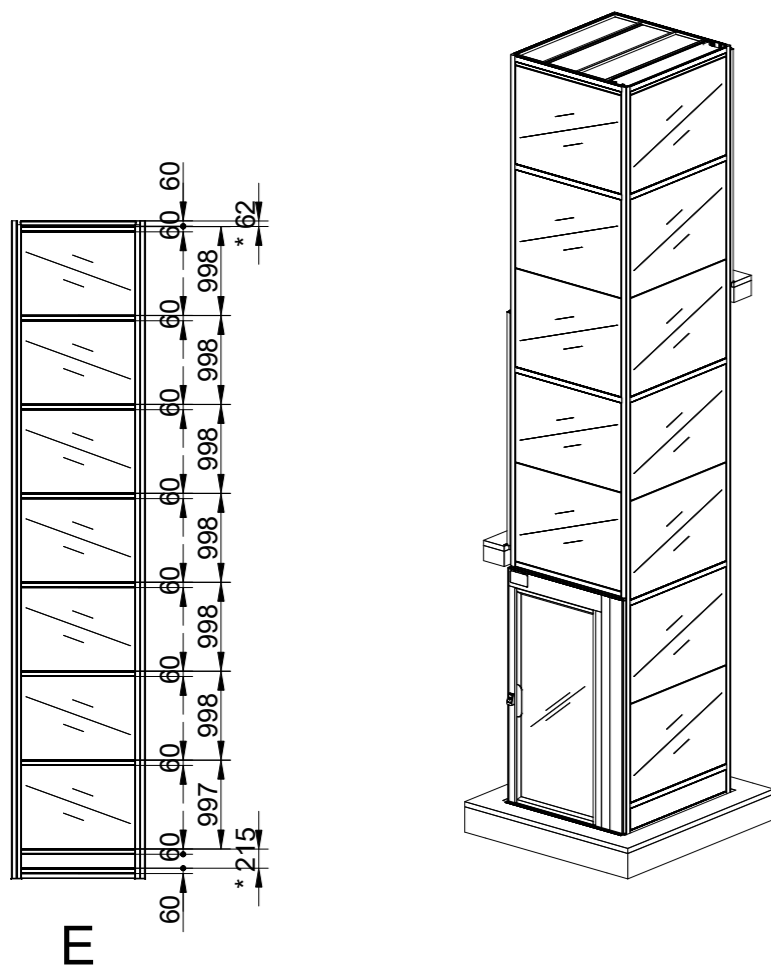

Positioning of machinery:

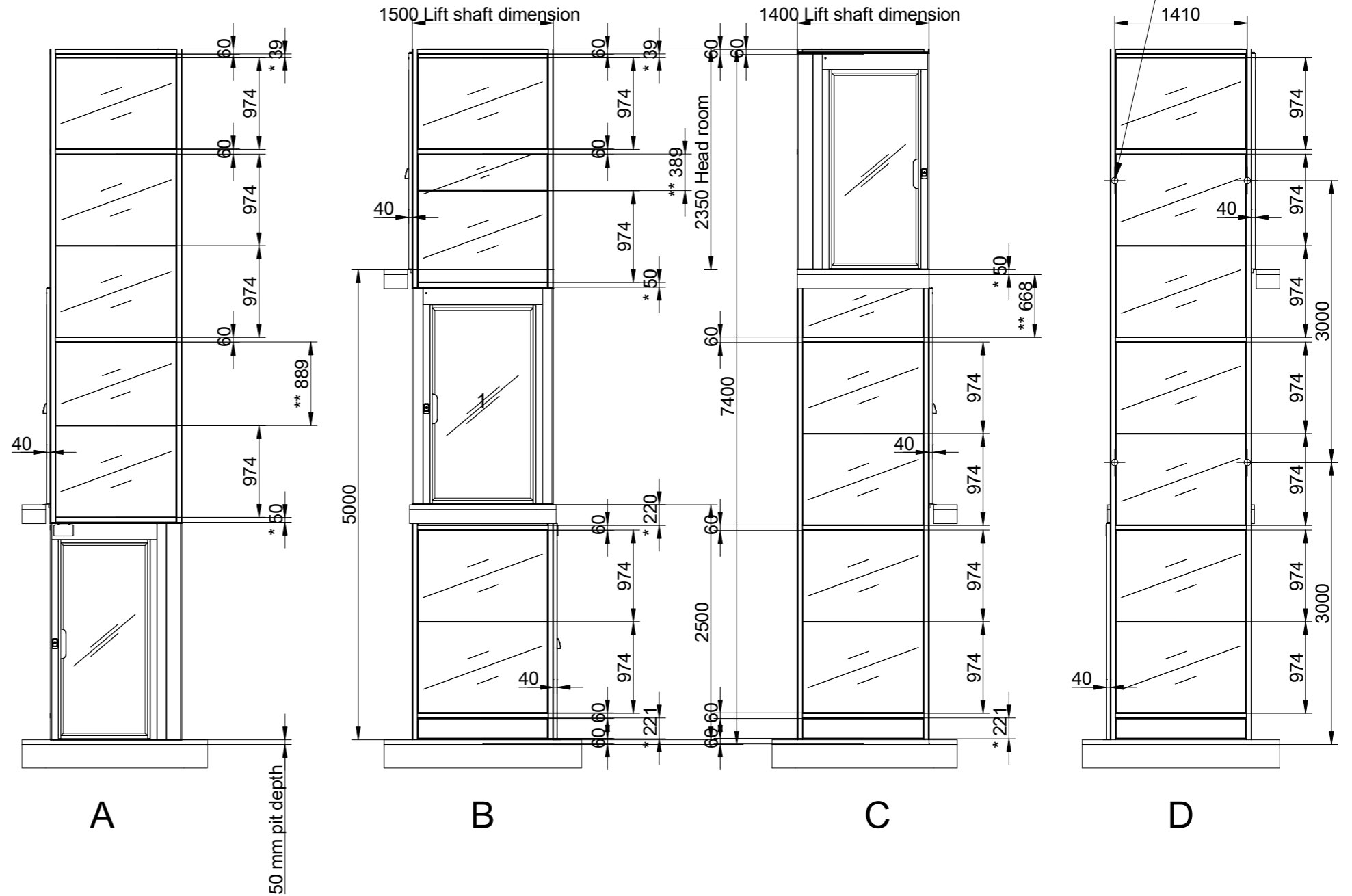
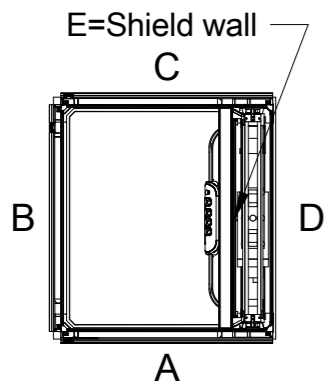

Options  
400 kg  
Power supply 1x230

Approved by builder:

European view placement:



Tender no  
202307101776

Gen. Tolerances  
SS-ISO 27681-1 m

Principal drawing

1 - 1025\*1450

Shaft drawing  
Johanna Aaw Kalea 3 pl  
1025x1450

Date  
2023-07-10  
06:04

sheet  
1 of 7

Scale:  
A3, 1:50

# Shaft cutout sizes

| Door front cutout sizes |       |        |
|-------------------------|-------|--------|
| Landing                 | Width | Height |
| A 0                     | 1470  | 2315   |
| B 1                     | 1600  | 2315   |
| C 2                     | 1470  | 2315   |

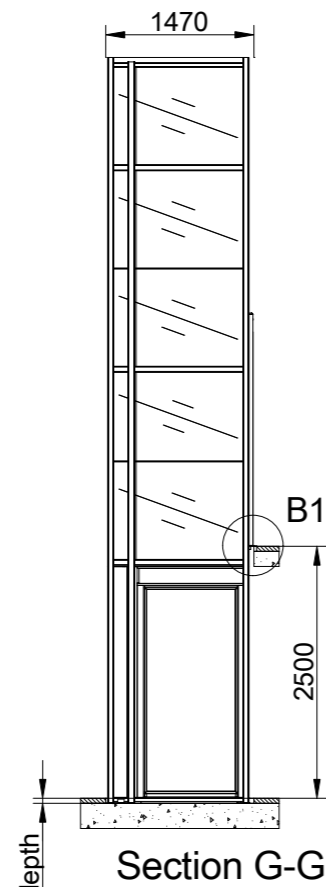
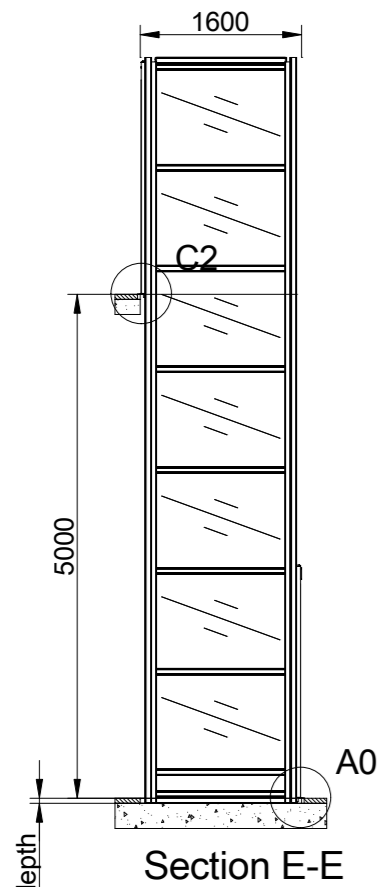
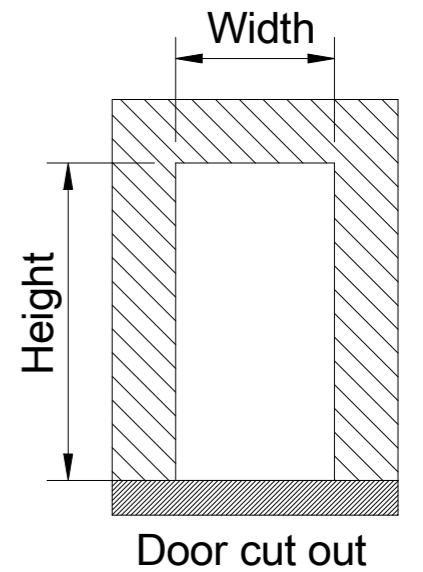

50 mm pit depth + 10 mm, - 0 mm.  
Bottom surface must be flat

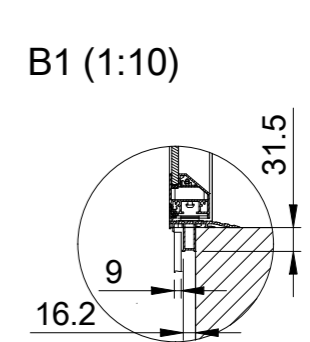
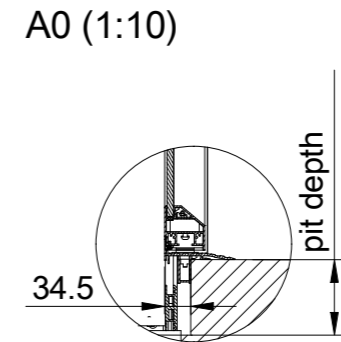
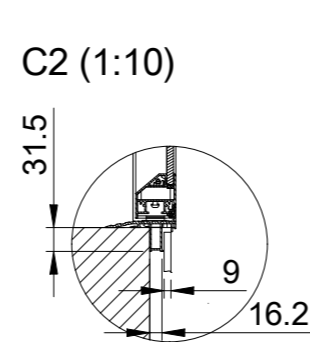
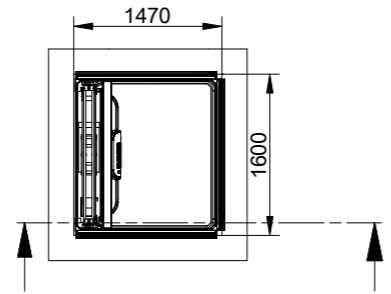
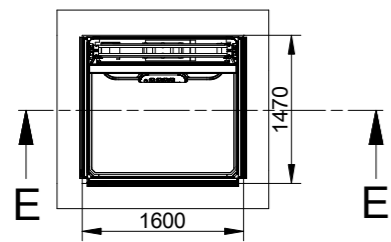

Approved by builder:



Tender no  
202307101776

Principal drawing  
1 - 1025\*1450  
Cut out sizes  
Johanna Aaw Kalea 3 pl  
1025x1450

European view placement:



Gen. Tolerances  
SS-ISO 27681-1 m

Date  
2023-07-10  
06:04

sheet  
2 of 7

Scale:  
A3, 1:50

6 5 4 3 2 1

Loads sustained by shaft and platform  
and fixing points bottom frame

Loads per fixing point:  
F=3200 N if the distance between the fixing points is 2999 mm or less  
F=2200 N if the distance between the fixing points is 3000 mm or more



L section force: 5.7 kN  
L section load:  
Weight on L-section  
area: 570 kg



Mast force: 15.58 kN  
Mast load:  
Weight on mast area (including rated load) 1558 kg

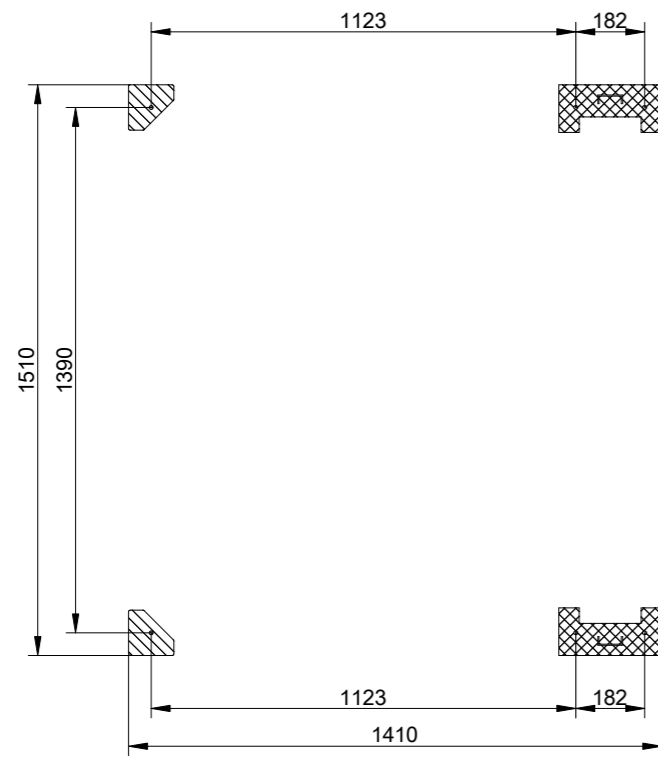

Scale: 1:20

Total weight of the lift equipment (including rated load)  
2127 kg

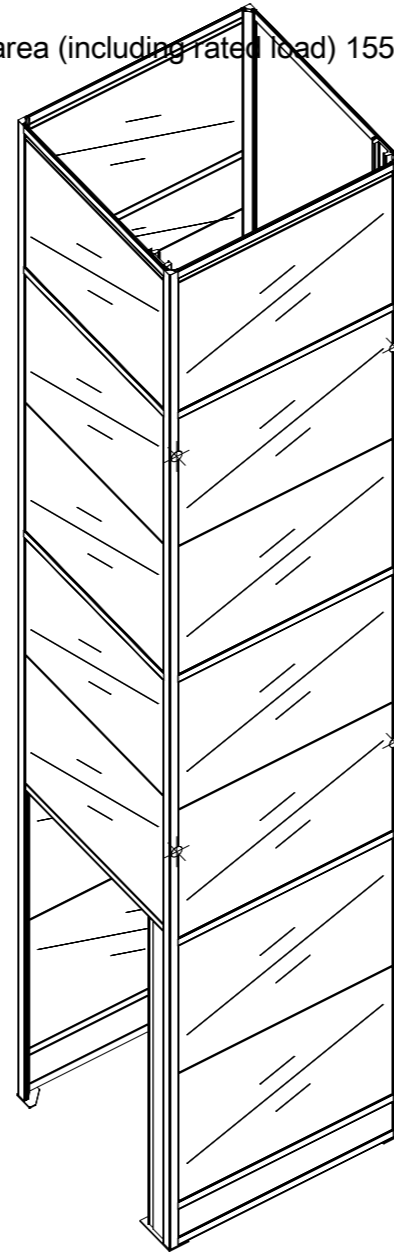

Fixing points  
See detail A

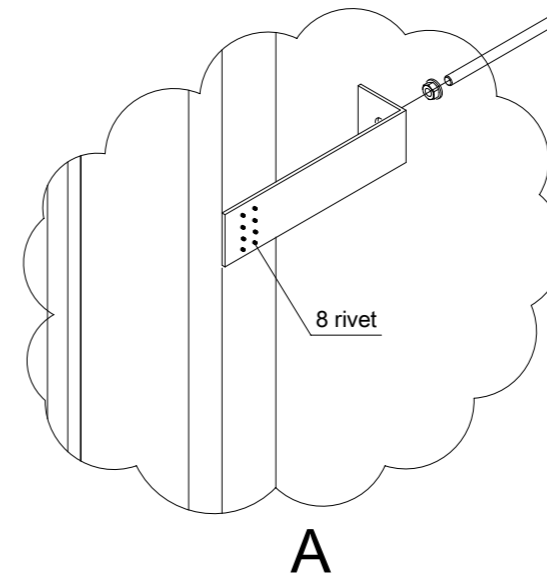

D

C

B

A

D

C

B

A

6 5 4 3 2 1

Approved by builder:

European view placement:



Tender no  
202307101776

Gen. Tolerances  
SS-ISO 27681-1 m

Principal drawing

1 - 1025\*1450

Loads and forces  
Johanna Aaw Kalea 3 pl  
1025x1450

Date  
2023-07-10  
06:04

sheet  
3 of 7

Scale:  
A3, 1:50

6 5 4 3 2 1

Landing 0 and door front information  
Scale: 1:20

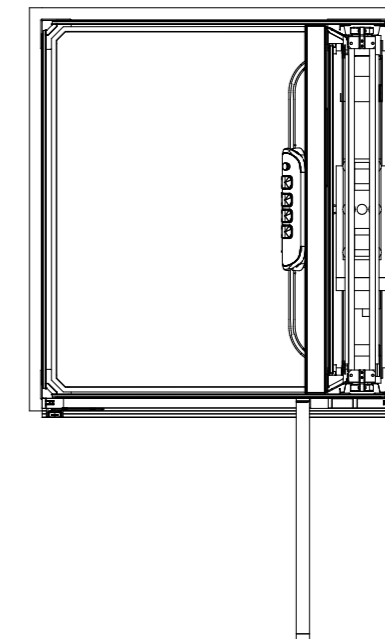
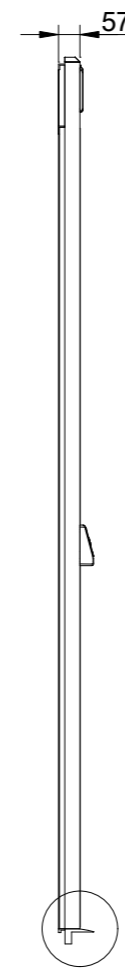
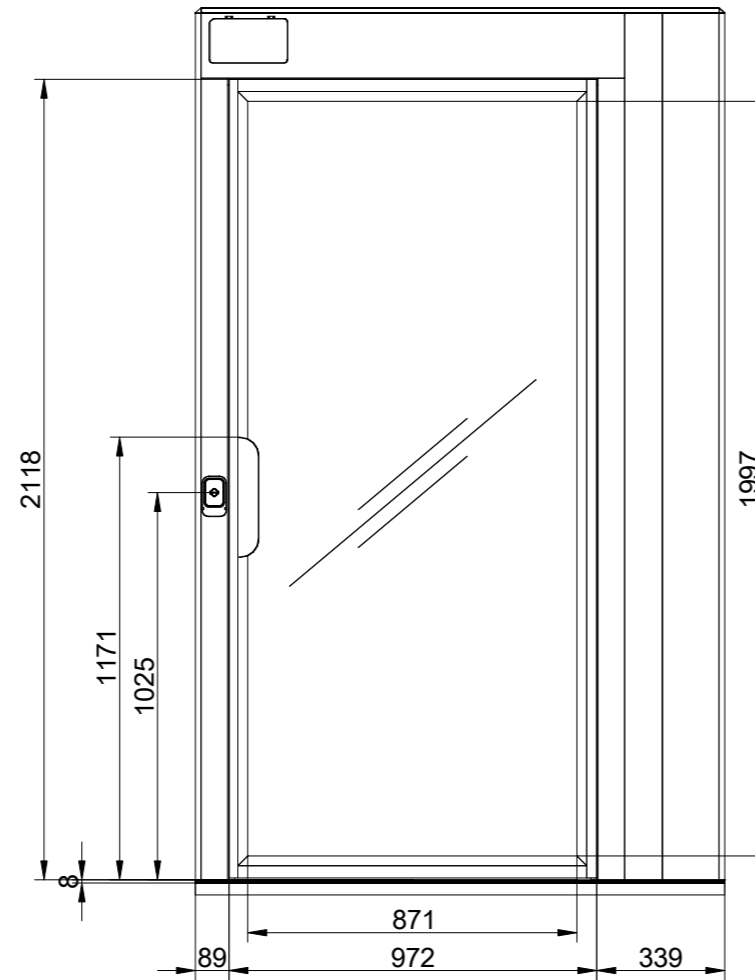
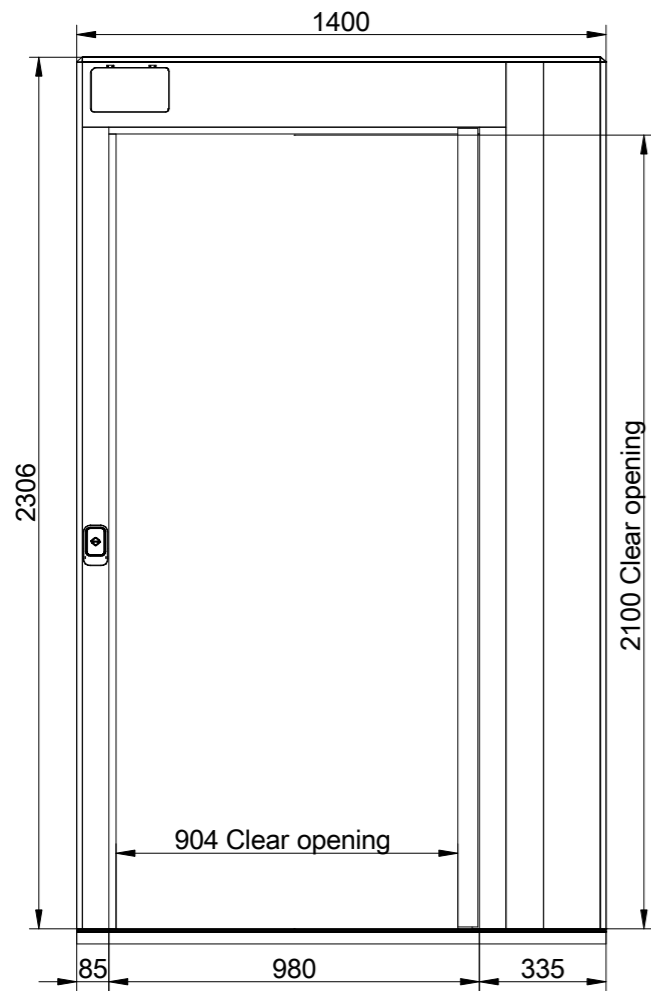

Scale: 1:30

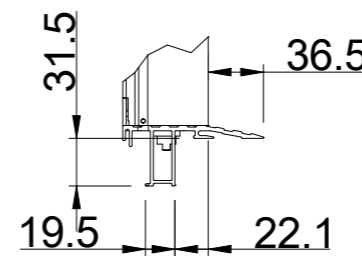

A (1:5)

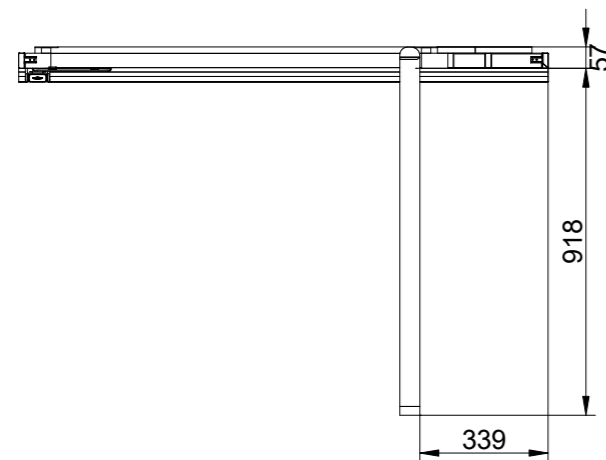

| Landing | Door type      |
|---------|----------------|
| 0       | Panoramic Plus |
| 1       | Panoramic Plus |
| 2       | Panoramic Plus |

Approved by builder:

European view placement:



Tender no  
202307101776

Gen. Tolerances  
SS-ISO 27681-1 m

Principal drawing

1 - 1025\*1450

Cut out sizes  
Johanna Aaw Kalea 3 pl  
1025x1450

Date  
2023-07-10  
06:04

sheet  
4 of 7

Scale:  
A3, 1:50

Landing 1 and door front information  
Scale: 1:20

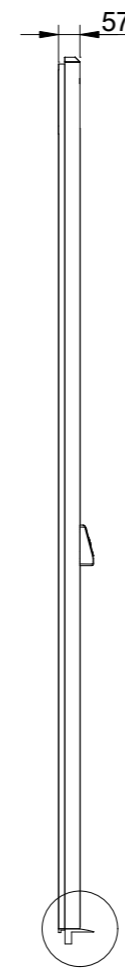
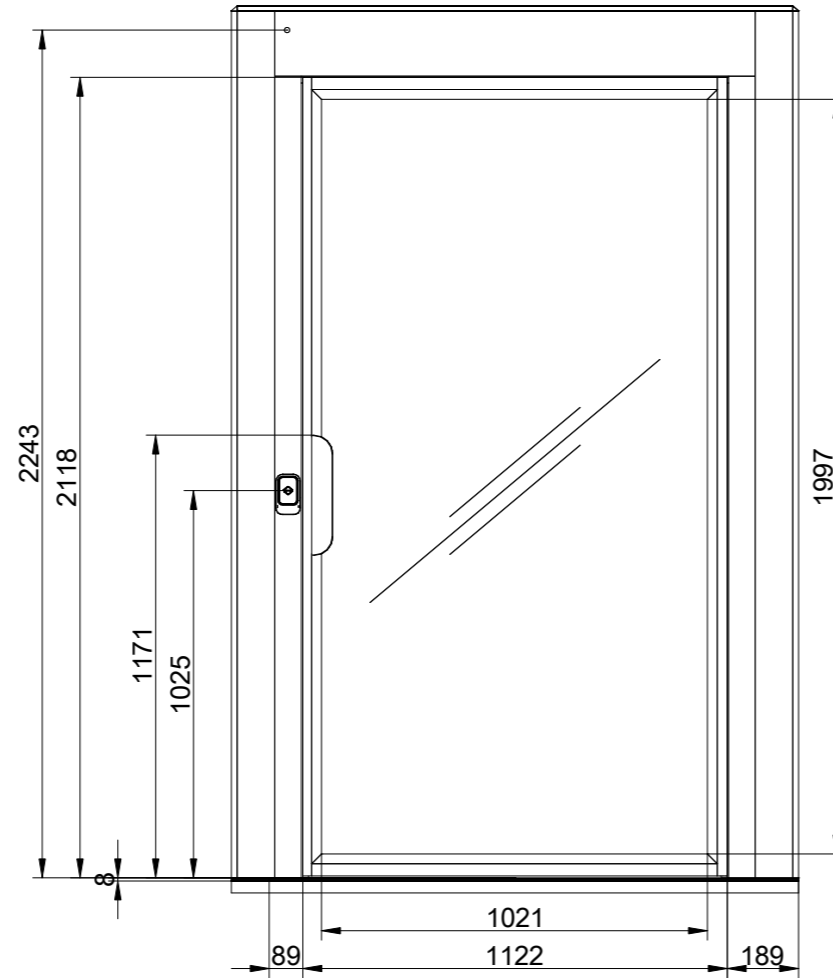
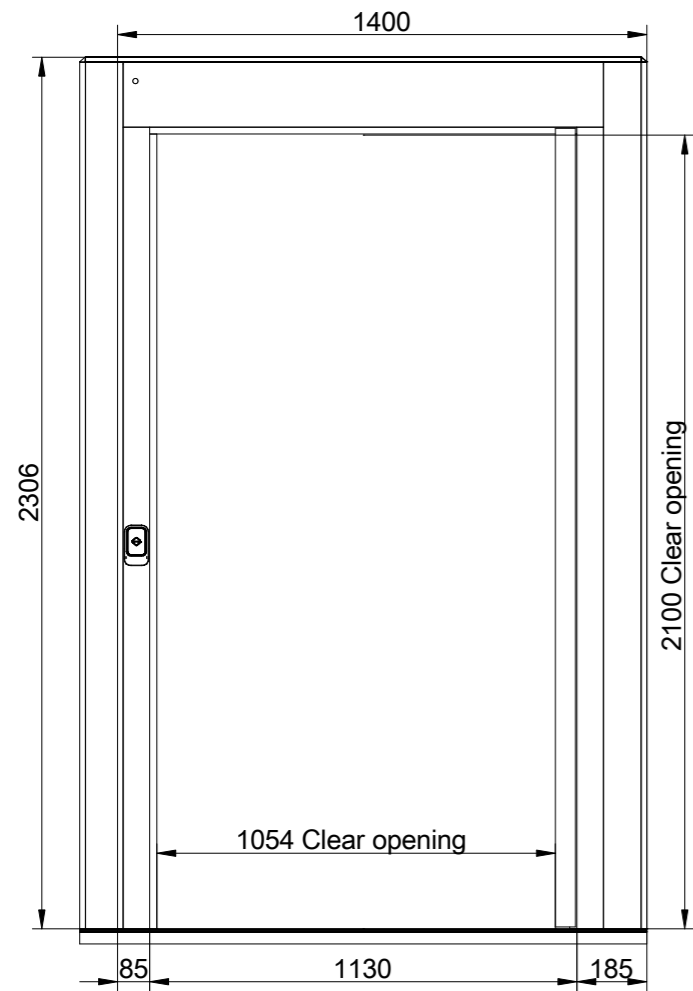

A

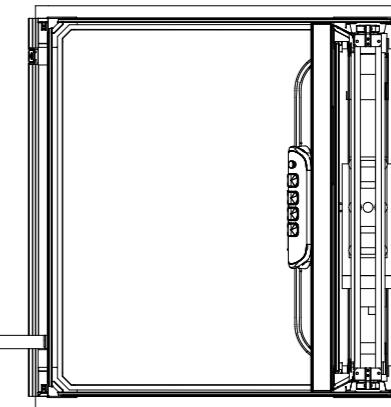

Scale: 1:30

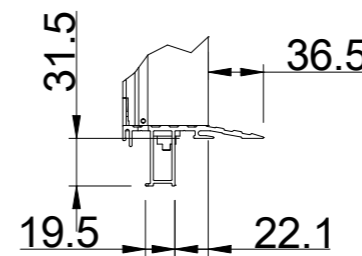
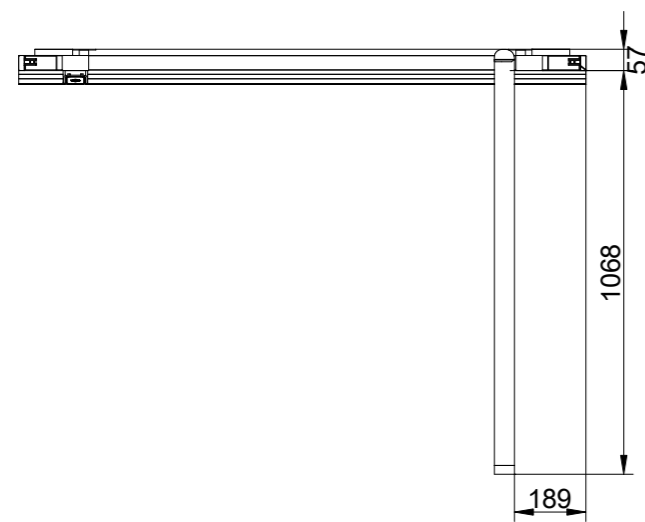

A (1:5)

| Landing | Door type      |
|---------|----------------|
| 0       | Panoramic Plus |
| 1       | Panoramic Plus |
| 2       | Panoramic Plus |

Approved by builder:

European view placement:



Tender no  
202307101776

Gen. Tolerances  
SS-ISO 27681-1 m

Principal drawing

1 - 1025\*1450

Landing information  
Johanna Aaw Kalea 3 pl  
1025x1450

Date  
2023-07-10  
06:04

sheet  
5 of 7

Scale:  
A3, 1:50

Landing 2 and door front information  
Scale: 1:20

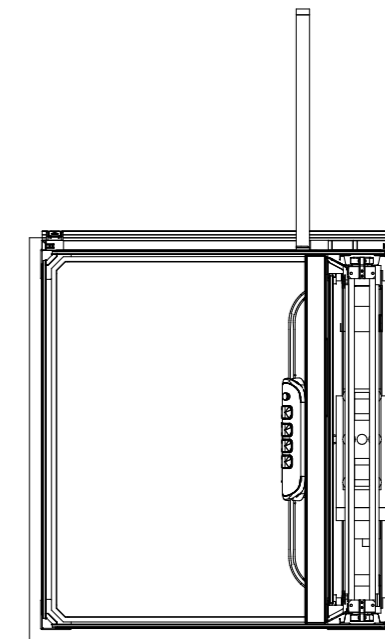
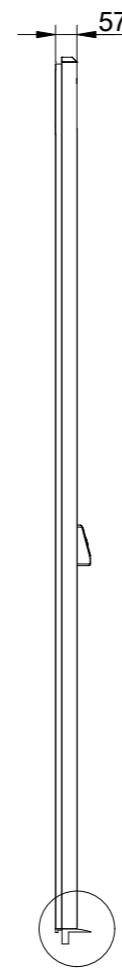
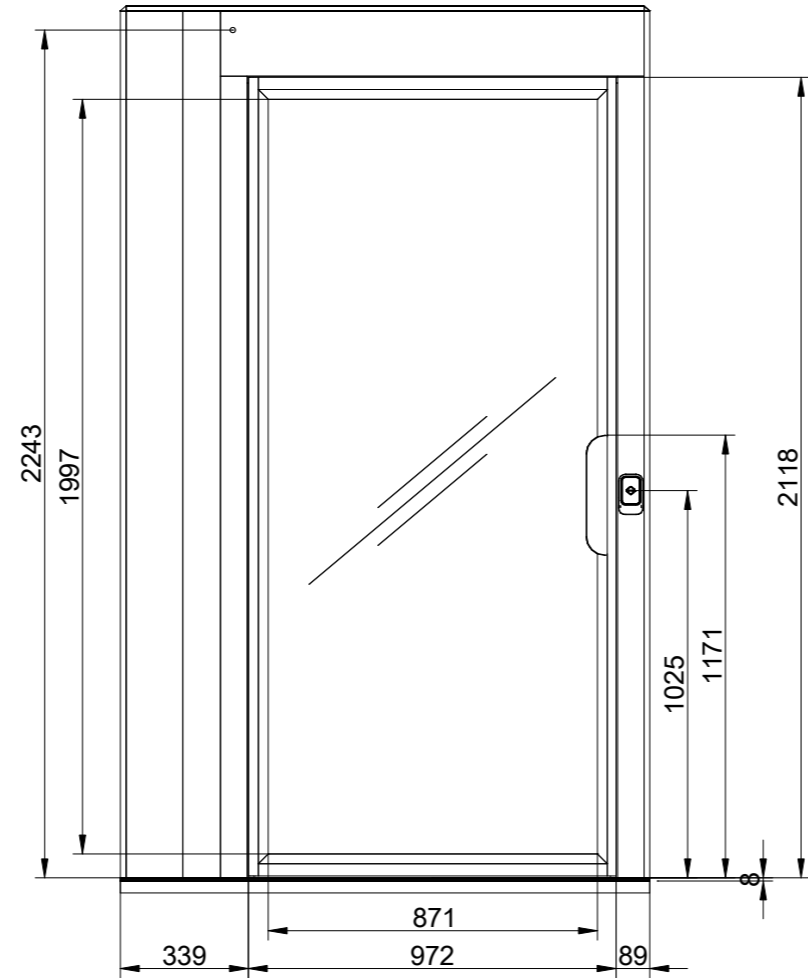
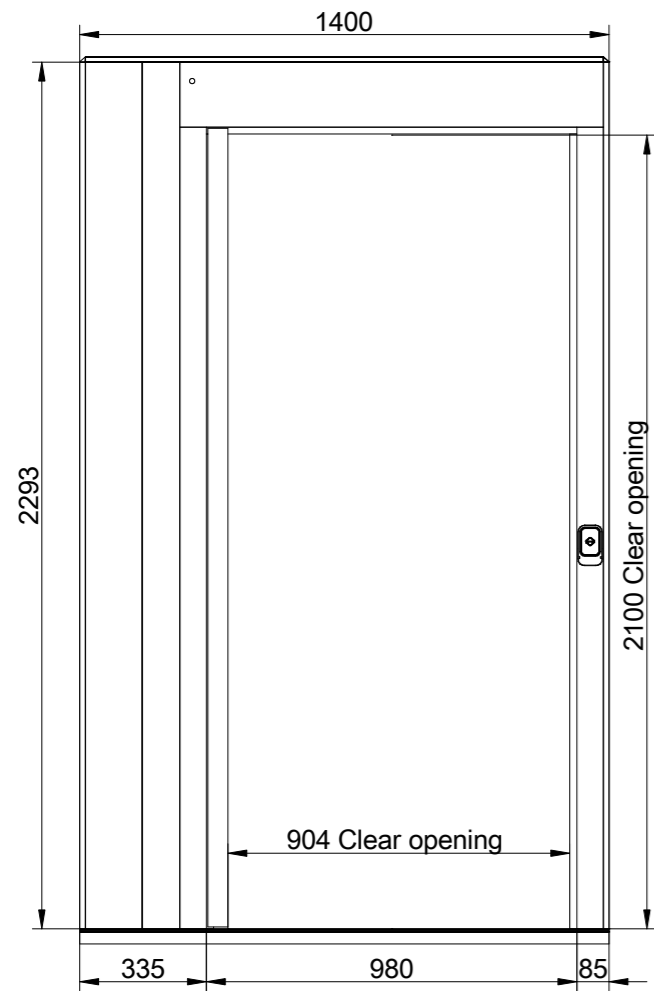

Scale: 1:30

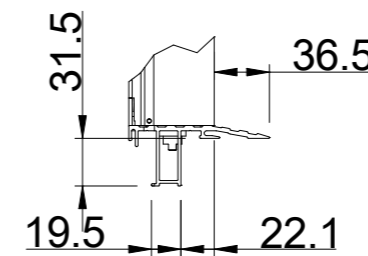
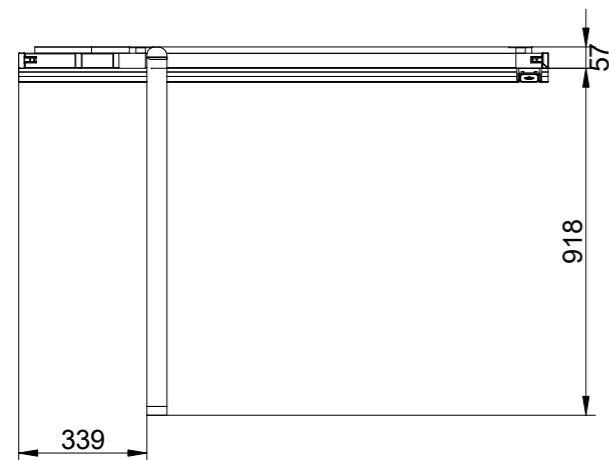

A (1:5)

| Landing | Door type      |
|---------|----------------|
| 0       | Panoramic Plus |
| 1       | Panoramic Plus |
| 2       | Panoramic Plus |

Approved by builder:

European view placement:



Tender no  
202307101776

Gen. Tolerances  
SS-ISO 27681-1 m

Principal drawing

1 - 1025\*1450

Landing information  
Johanna Aaw Kalea 3 pl  
1025x1450

Date  
2023-07-10  
06:04

sheet  
6 of 7

Scale:  
A3, 1:50

6 5 4 3 2 1

**Platform layout**  
Scale: 1:15

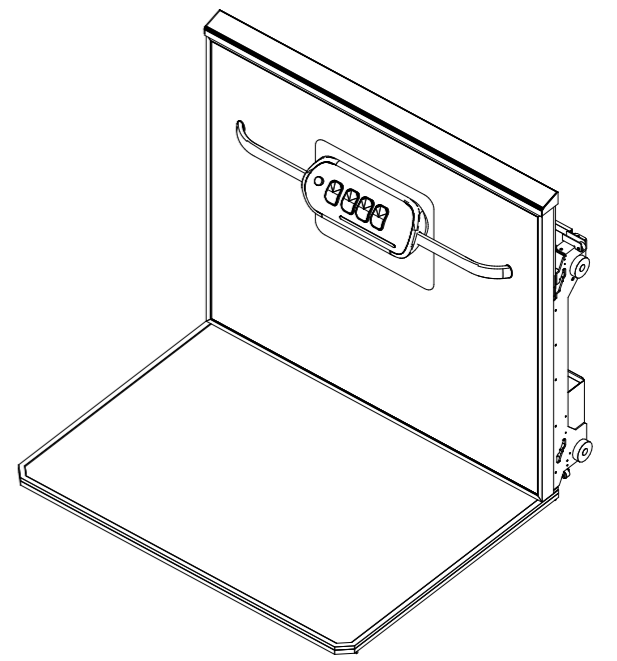
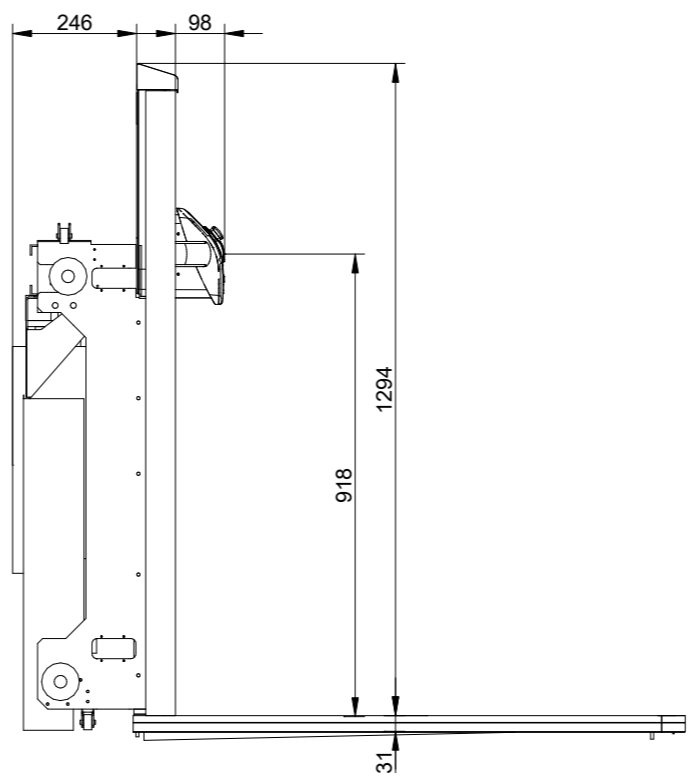
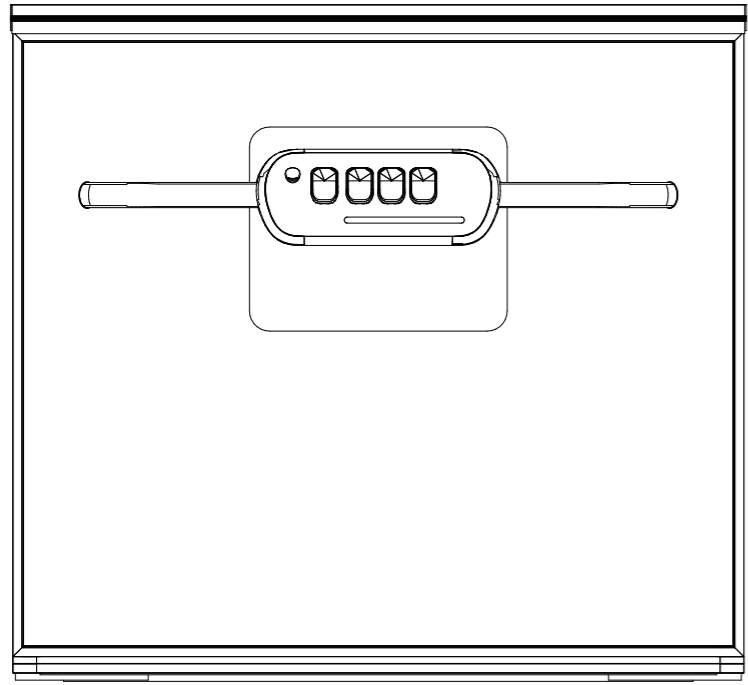

**Platform dimensions**  
Scale: 1:15

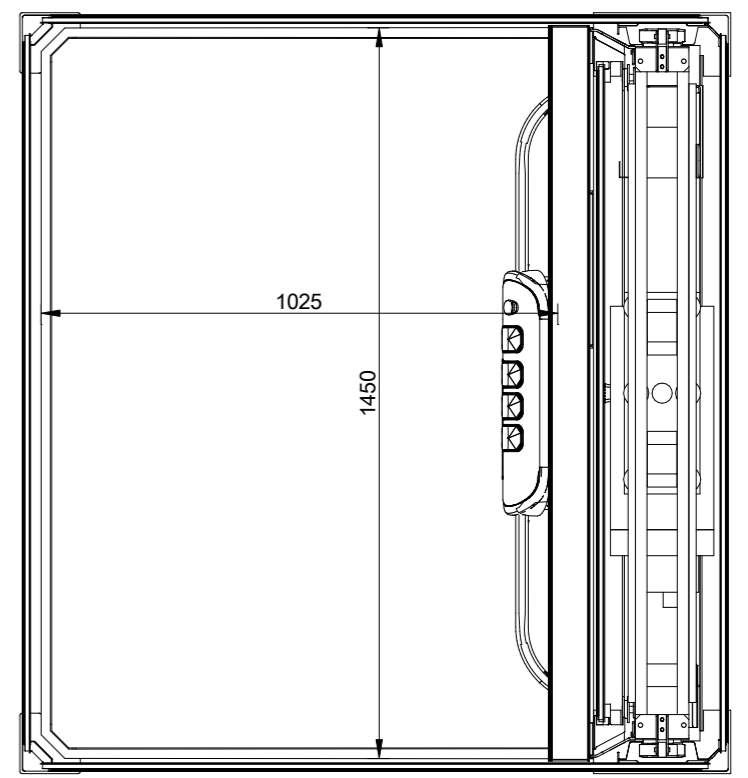

**Button layout**  
Scale: 1:10

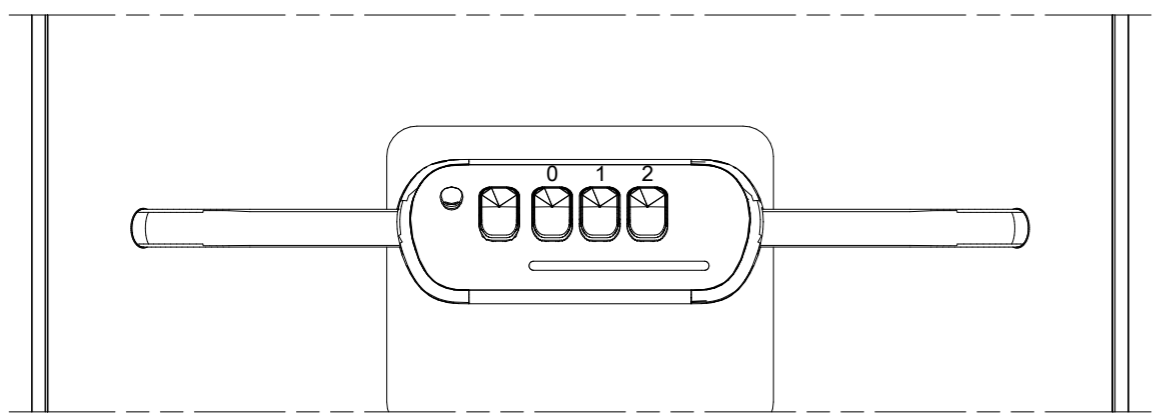

|                                   |                       |  |              |
|-----------------------------------|-----------------------|--|--------------|
| Approved by builder:<br><br>_____ | <b>KALEA</b><br>LIFTS | Principal drawing                                      |              |
|                                   |                       | 1 - 1025*1450  |              |
| European view placement:          |                       | Tender no  | 202307101776 |
|                                   |                       | Platform layout<br>Johanna Aaw Kalea 3 pl<br>1025x1450 |              |
| Gen. Tolerances                   | Date                  | sheet  | Scale:       |
| SS-ISO 27681-1 m                  | 2023-07-10<br>06:04   | 7 of 7   | A3, 1:50     |

6 5 4 3 2 1